

HSF

NOTES:

Rated Current: See Table \triangle
 Contact Resistance: 30m Ω max
 Withstand Voltage: 1500V AC/Minute
 Insulation Resistance: 1000M Ω min
 Operation Temperature: -40°C to +105°C

Contact Material: Brass
 Contact Plating: Au Or Sn Over Ni
 Insulator Material: PA66(White Transparent UL94-V2 std) Or PA46(Natural UL94-V0)

Recommended P.C.B Layout(Top Side)
 (PCB BOARD TOLERANCE ± 0.05)

PART NO.	PIN	A	B	Material
WF4201-2WSHXXX6	2*5P及以下	+0.30 -0.10	+0.40 -0.20	PA46
	2*5P以上	+0.50 -0.00	+0.60 -0.00	
WF4201-2WSXXX6	2*1P-2*12P	± 0.20	± 0.30	PA66

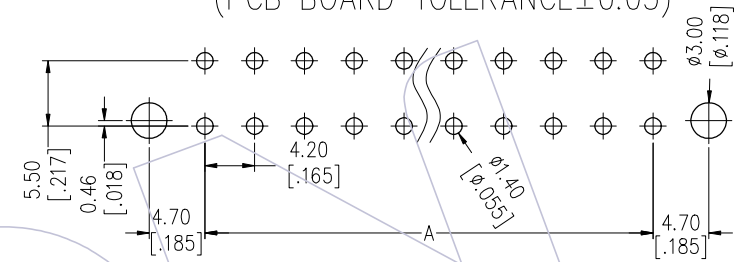

Size Wire	Ckt	2&3	4-6	7-10	12-24
AWG#18		9A	8A	7A	6A
AWG#20		7A	6A	5A	5A
AWG#22		5A	4A	4A	4A
AWG#24		4A	3A	3A	3A

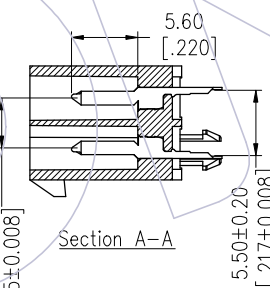
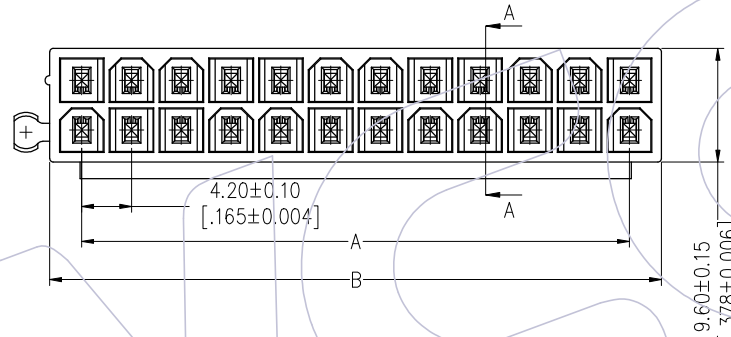

Dimensional & Ordering Information

Circuit	Part No.	Dimension		
		A	B	L
2x01	WF4201-2WS01W06	---	5.40	4.20
2x02	WF4201-2WS02W06	4.20	9.60	4.20
2x03	WF4201-2WS03W06	8.40	13.80	8.70
2x04	WF4201-2WS04W06	12.60	18.00	12.90
2x05	WF4201-2WS05W06	16.80	22.20	17.10
2x06	WF4201-2WS06W06	21.00	26.40	21.30
2x07	WF4201-2WS07W06	25.20	30.60	25.50
2x08	WF4201-2WS08W06	29.40	34.80	29.70
2x09	WF4201-2WS09W06	33.60	39.00	33.90
2x10	WF4201-2WS10W06	37.80	43.20	38.10
2x11	WF4201-2WS11W06	42.00	47.40	42.30
2x12	WF4201-2WS12W06	46.20	51.60	46.50

Ordering Information

WF4201 -2WS XX W A 6

No. of Row Dual Row
 No. of pins 01-12P
 Contact Plating
 S0=Gold Flash/Tin
 S3=10u"Gold/Tin
 S4=15u"Gold/Tin
 S5=30u"Gold/Tin
 G0=Gold Flash
 G3=10u"Gold
 G4=15u"Gold
 G5=30u"Gold
 Blank=Tin
 Insulation Material
 H=PA46
 Blank=PA66
 Color
 B=Black
 T=Natural
 W=White Transparent
 Packing
 0=PE Bag
 A=Tray

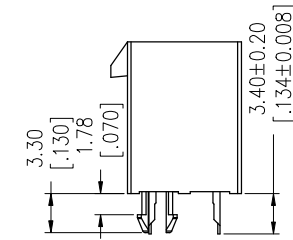
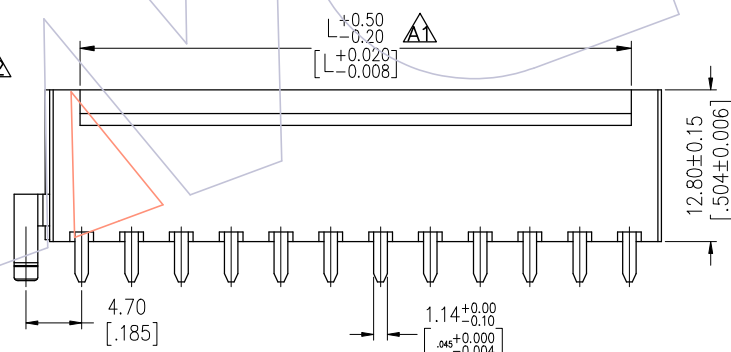

REV	DATE	MODIFICATION DESCRIPTION	CHANGE	OPERATION	DRAW CP	DATE	SCALE	FIT	PART NO.
A2	2024/05/11	Modify Rated Current: See Table	CP	x.x ±0.40	CP	2024/05/11	UNIT	mm inch	SEE TABLE
A1	2019/05/15	Modify	---	x.xx ±0.25	CHECK	DATE	SIZE	A4	TITLE: 4.20 MINI FIT DUAL ROW 180° WITH LONG BUMP AND SINGLE POST
AO	2012/09/17	NEW	---	x.xxx ±0.15	APPROVE	DATE	SHEET	1/2	Customer NO.
				Angle ± 3°			PROJ.		
				DIM TOL					

WCON
 Http: www.wcon.com

WCON-Dongguan
 Tel: +86 769 85358920
 Fax: +86 769 85358915
 E-mail: sales@wcon.com

WCON-Kunshan
 Tel: +86 512 57468408
 Fax: +86 512 57468468
 E-mail: salesks@wcon.com

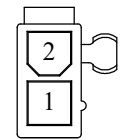

2x01P

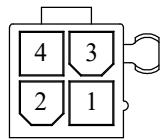

2x02P

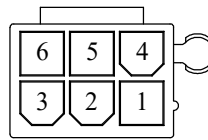

2x03P

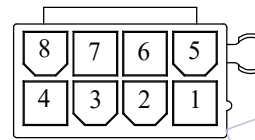

2x04P

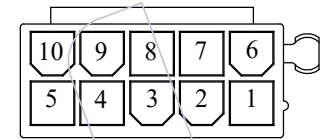

2x05P

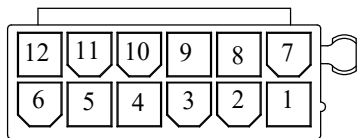

2x06P

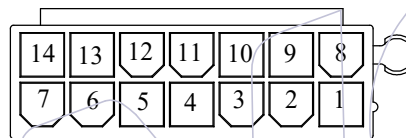

2x07P



2x08P

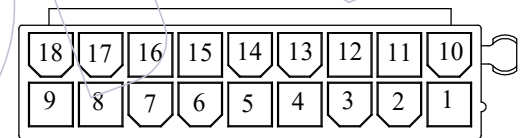

2x09P

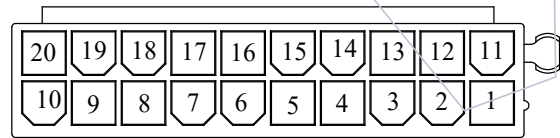

2x10P

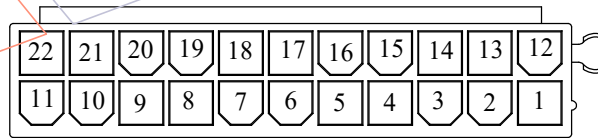

2x11P

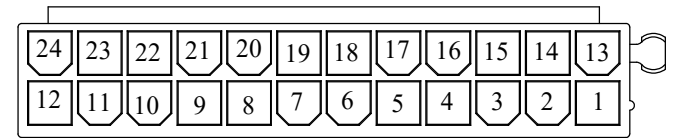

2x12P

REV	DATE	MODIFICATION DESCRIPTION	CHANGE	OPERATION	DRAW CP	DATE	SCALE	FIT	PART NO.
A2	2024/05/11	Modify Rated Current: See Table	CP	x.x ±0.40	CHECK	2019/05/15	UNIT	mm inch	WF4201-2WSXXWX6
A1	2019/05/15	Modify	---	x.xx ±0.25	APPROVE	DATE	SIZE	A4	TITLE: 4.20 MINI FIT DUAL ROW 180° WITH LONG BUMP AND SINGLE POST
AO	2012/09/17	NEW	---	x.xxx ±0.15	DATE	DATE	SHEET	2/2	Customer NO.
				Angle ± 3° DIM TOL			PROJ.		



WCON-Dongguan Tel: +86 769 85358920 Fax: +86 769 85358915 E-mail: sales@wcon.com
 WCON-Kunshan Tel: +86 512 57468408 Fax: +86 512 57468468 E-mail: salesks@wcon.com