

HSF

NOTE:
Rated Current: See Table 1
Rated Voltage: 50 V AC(RMS)/DC;
Contact Resistance: 20mΩ Max;
Withstanding Voltage: 500V AC;
Insulation Resistance: 100MΩ Min;
Temperature Range: -40°C ~ +125°C
(Includes the terminal temperature rise)

Insulator Material: PBT, G.F, UL94 V-0, BK
Fit With Terminal: WF1258-TPXX01

Ordering Information

WF1258- 2 H XX B 0 1 W
2=DUAL ROW
NO. OF CIRCUITS PER ROW
04=4 CIRCUITS
COLOR:
B=BLACK
PACKING:
0=PE BAG
W=WITH "W" LOGO

TABLE 1:
CURRENT DERATING AT 23°C
(MATED WITH WF1258 WAFER(Dual Row) & HOUSING TERMINAL FOR TEST)

AWG#	Amps(A) Max				
	2X4 CIRCUITS	2X8 CIRCUITS	2X12 CIRCUITS	2X16 CIRCUITS	2X21 CIRCUITS
26	2.4	1.8	1.7	1.6	1.5
28	2.1	1.6	1.5	1.4	1.3
30	1.8	1.4	1.3	1.2	1.1

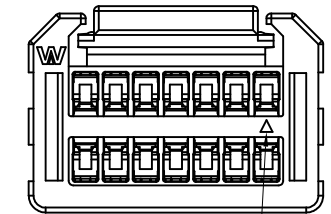
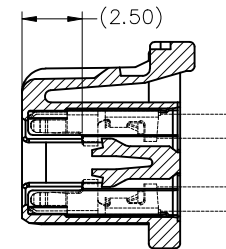
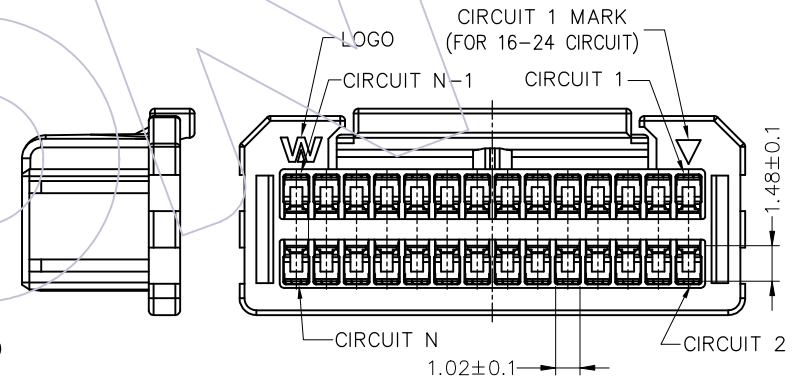
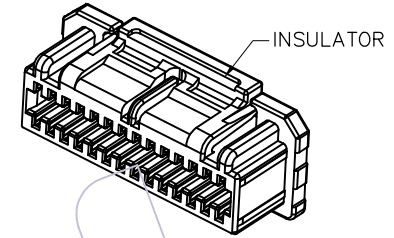
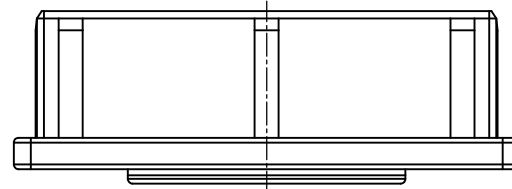
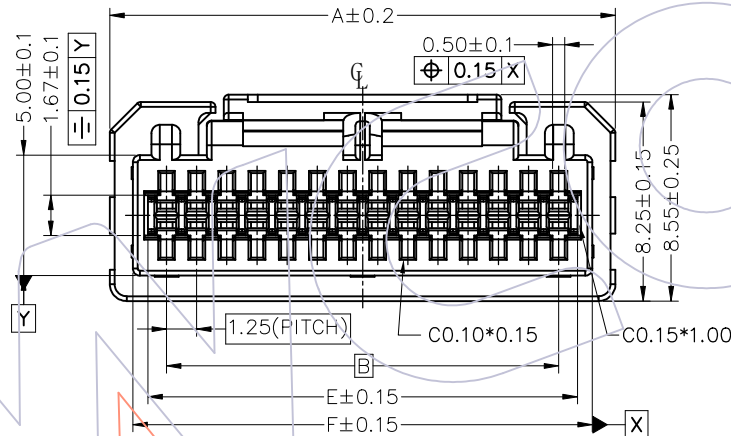
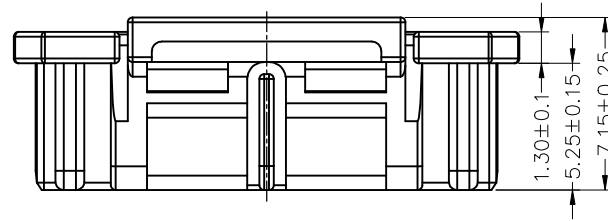

TERMINAL ASSEMBLY DRAWING

CIRCUIT 1 MARK
(FOR 8-14 CIRCUIT)

REV	DATE	MODIFICATION DESCRIPTION	CHANGE	OPERATION		DRAW	DATE	SCALE	FIT	PART NO.
				X.X	±0.40					
A0	2024/06/05	NEW		X.XX	±0.25	XueLei	2024/06/05	UNIT	mm	WF1258-2HXXB01W
				X.XXX	±0.15	CHECK	DATE	SIZE	A4	TITLE: 1.25mm HOUSING, M Type, Dual Row
				Angle	± 3'	APPROVE	DATE	SHEET	1/3	Customer NO.
				DIM	TOL			PROJ.		

WCON
Http: www.wcon.com

WCON-Dongguan
Tel: +86 769 85358920
Fax: +86 769 85358915
E-mail: sales@wcon.com

WCON-Kunshan
Tel: +86 512 57468408
Fax: +86 512 57468468
E-mail: sales@wcon.com

HSF

PRODUCT SHAPE

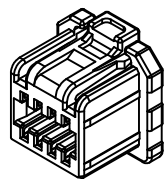

2X(4~7) CIRCUIT

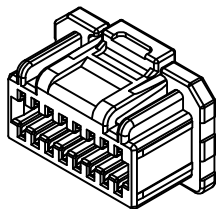

2X(8~12) CIRCUIT

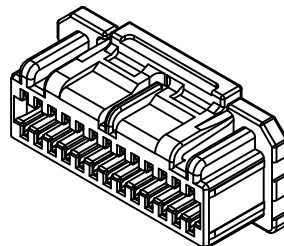

2X(13~16) CIRCUIT

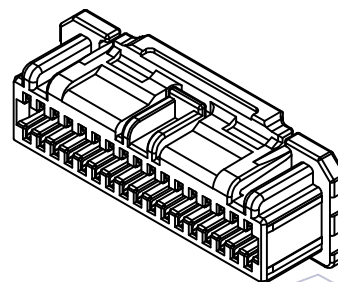

2X(17~20) CIRCUIT

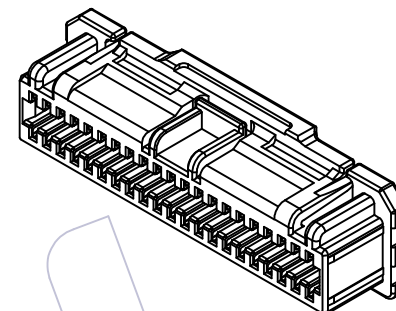

2 X21 CIRCUIT

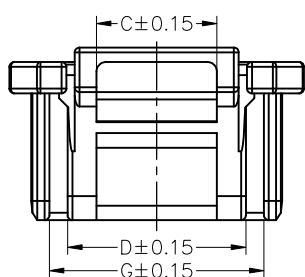

2X(4~7) CIRCUIT

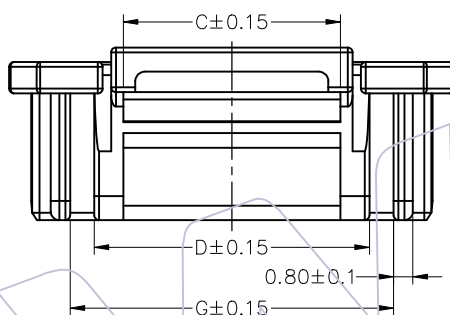

2X(8~12) CIRCUIT

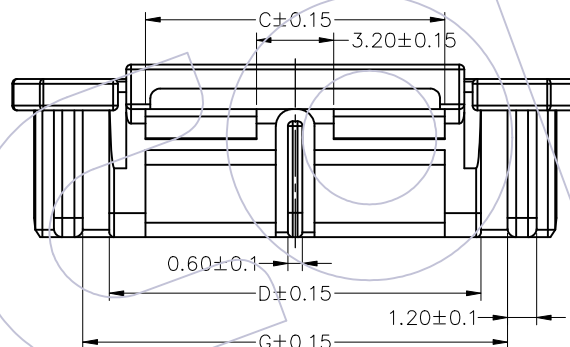

2X(13~16) CIRCUIT

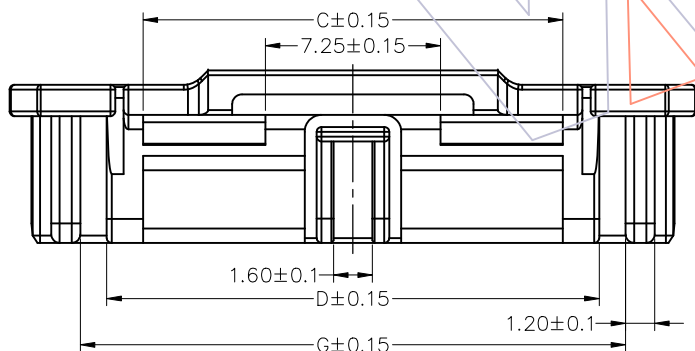

2X(17~20) CIRCUIT

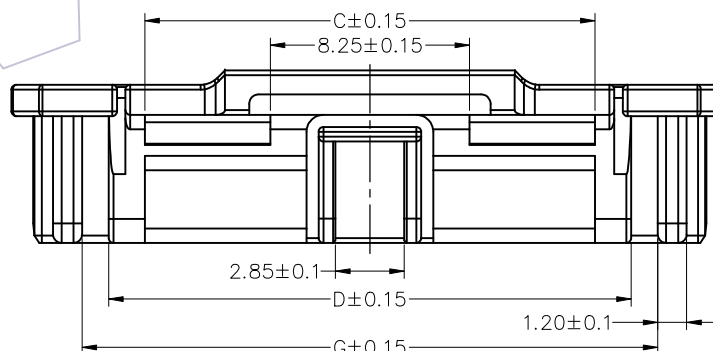

2X21 CIRCUIT

Circuit	A	B	C	D	E	F	G
2x4	8.45	3.75	1.94	3.64	5.30	6.54	5.14
2x5	9.70	5.00	3.19	4.89	6.55	7.79	6.39
2x6	10.95	6.25	4.44	6.14	7.80	9.04	7.64
2x7	12.20	7.50	4.99	7.39	9.05	10.29	8.89
2x8	13.45	8.75	4.00	6.40	10.30	11.54	8.40
2x9	14.70	10.00	5.25	7.65	11.55	12.79	9.65
2x10	15.95	11.25	6.50	8.90	12.80	14.04	10.90
2x11	17.20	12.50	7.75	10.15	14.05	15.29	12.15
2x12	18.45	13.75	9.00	11.40	15.30	16.54	13.40
2x13	19.70	15.00	8.65	11.65	16.55	17.79	13.85
2x14	20.95	16.25	9.90	12.90	17.80	19.04	15.10
2x15	22.20	17.50	11.15	14.15	19.05	20.29	16.35
2x16	23.45	18.75	12.40	15.40	20.30	21.54	17.60
2x17	24.70	20.00	13.65	16.65	21.55	22.79	18.85
2x18	25.95	21.25	14.90	17.90	22.80	24.04	20.10
2x19	27.20	22.50	16.15	19.15	24.05	25.29	21.35
2x20	28.45	23.75	17.40	20.40	25.30	26.54	22.60
2x21	29.70	25.00	18.65	21.65	26.55	27.79	23.85

OPERATION	
X.X	±0.40
X.XX	±0.25
X.XXX	±0.15
Angle	± 3'
DIM	TOL

DRAW
CHECK
APPROVE

DATE
2024/06/05
DATE
DATE

SCALE	FIT
UNIT	mm
SIZE	A4
SHEET	2/3
PROJ.	⌀

PART NO.
WF1258-2HXXB01W
TITLE:
1. 25mm HOUSING, M Type,
Dual Row
Customer NO.



WCON-Dongguan Tel: +86 769 85358920 Fax: +86 769 85358915 E-mail: sales@wcon.com	WCON-Kunshan Tel: +86 512 57468408 Fax: +86 512 57468468 E-mail: salesks@wcon.com
---	--

A0	2024/06/05	NEW	
REV	DATE	MODIFICATION DESCRIPTION	CHANGE

HSF

MATED WITH WF1258 WAFER (180° SMT TYPE)

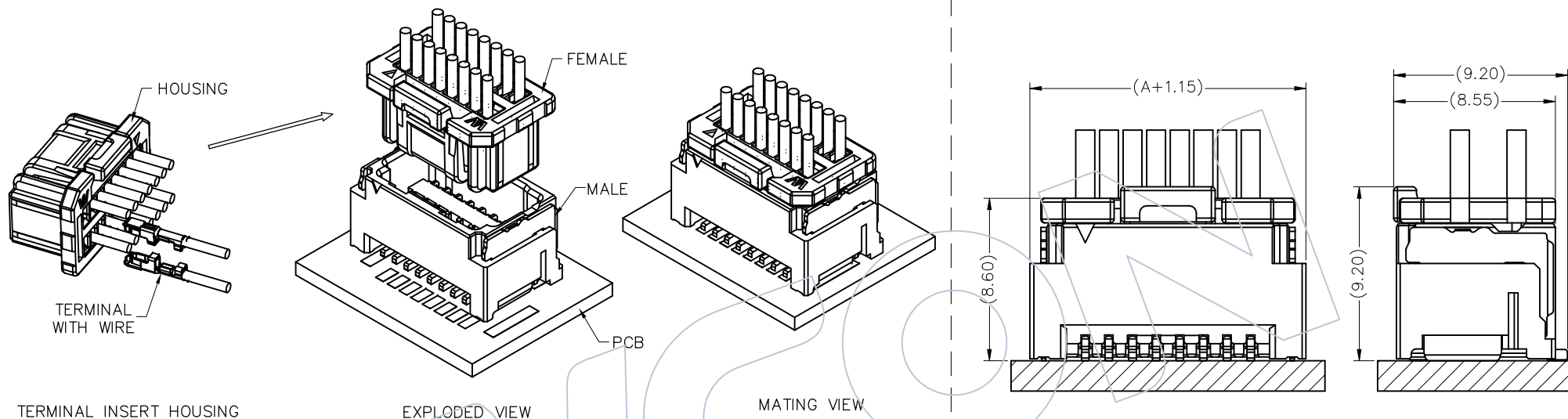

MATED WITH WF1258 WAFER (90° SMT TYPE)

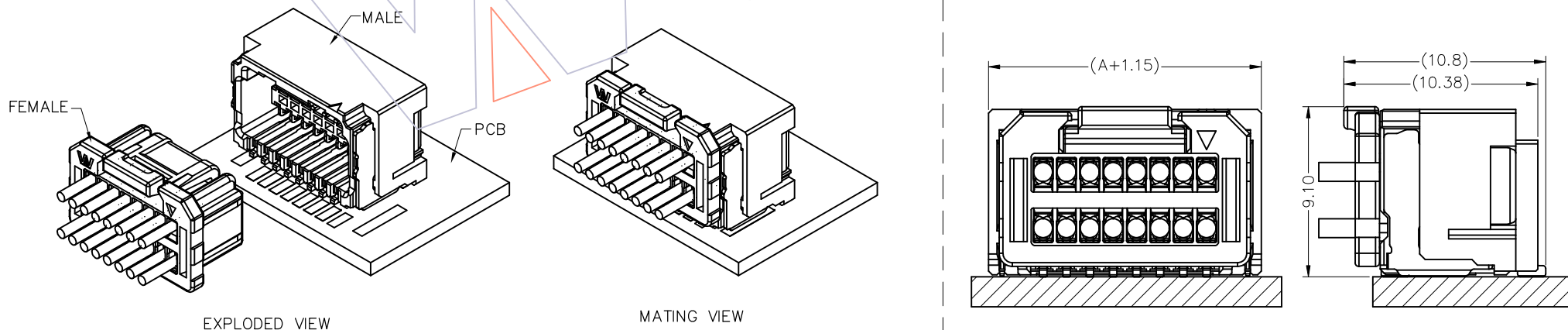

				OPERATION		DRAW	DATE	SCALE	FIT	PART NO.	
				X.X	±0.40	XueLei	2024/06/05	UNIT	mm	WF1258-2HXXB01W	
				X.XX	±0.25		DATE	SIZE	A4	TITLE:	
				X.XXX	±0.15	APPROVE	DATE	SHEET	3/3	1. 25mm HOUSING, M Type,	
				Angle	± 3'		DATE	PROJ.	⌀	Dual Row	
REV	DATE	MODIFICATION DESCRIPTION		CHANGE	DIM	TOL				Customer NO.	
A0	2024/06/05	NEW									

WCON
Http: www.wcon.com

WCON-Dongguan
Tel: +86 769 85358920
Fax: +86 769 85358915
E-mail: sales@wcon.com

WCON-Kunshan
Tel: +86 512 57468408
Fax: +86 512 57468468
E-mail: salesks@wcon.com