

HSPF

UL&CSA GRADE:

UL Style.....2651

Rate Temperature.....-20°C TO 105°C

Rate Voltage.....Max 300V

Flame Test....VW-1

CSA Standard.....C22.2 NO.210.2

Rate Temperature.....-20°C TO 105°C

Rate Voltage.....Max 300V

Flame Test.....FT1,FT2

Physical Property:

Stranded Conductor

AWG Size.....28AWG

Material of Insulation.....Polyvinyl Chloride(PVC)

Insulation thickness average.....9 mil

Min Insulation Thickness.....7 mil

Electronic Characteristics:

Spark test.....2500V

Dielectric strength test.....Min 2KV in 1 minute

Conductor resistance.....Max 237Ω/km

Insulation resistance.....Min 100MΩ-km

Capacity.....55PF/m(G-S-G)

Inductance.....1.45μH/m

Impedance.....100Ω(G-S-G)

Propagation delay time.....4.2 ns/m

UL NO:E169626

Ordering Information

F1U-B 28 G XX D0 - XXXX-X

PITCH
1.0

Flat Cable Length

No. of Pins
04-64P

Marking:

AWM 2651 28AWG 105° C 300V VW-1 E332441 YA0BO c\AWM1A 105° C 300V FT1

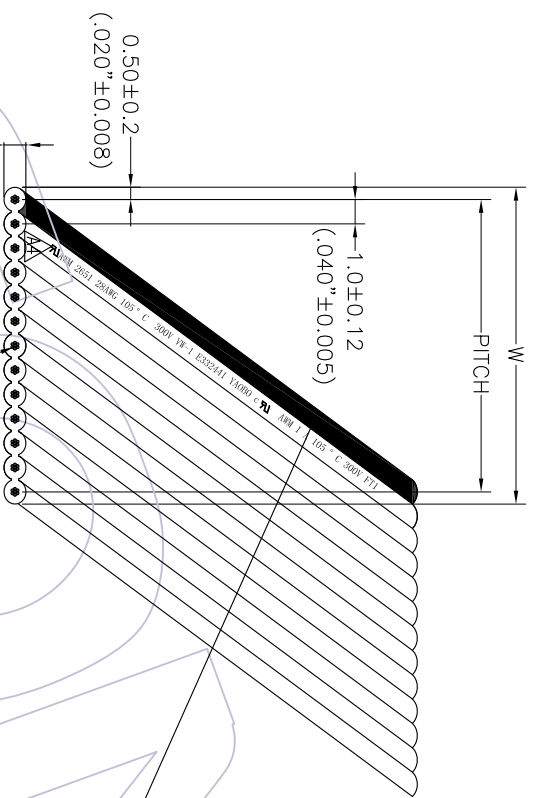

NUMBER OF CORES	WIDTH (mm)	Pitch (mm)	Allowable ERROR (mm)
4	4.00	3.00	±0.15
5	5.00	4.00	±0.15
6	6.00	5.00	±0.15
7	7.00	6.00	±0.15
8	8.00	7.00	±0.15
9	9.00	8.00	±0.15
10	10.00	9.00	±0.15
12	12.00	11.00	±0.15
14	14.00	13.00	±0.15
15	15.00	14.00	±0.15
16	16.00	15.00	±0.15
18	18.00	17.00	±0.15

NUMBER OF CORES	WIDTH (mm)	Pitch (mm)	Allowable ERROR (mm)
20	20.00	19.00	±0.15
25	25.00	24.00	±0.20
26	26.00	25.00	±0.20
28	28.00	27.00	±0.20
30	30.00	29.00	±0.20
34	34.00	33.00	±0.20
36	36.00	35.00	±0.20
37	37.00	36.00	±0.20
40	40.00	39.00	±0.20
50	50.00	49.00	±0.20
60	60.00	59.00	±0.20
64	64.00	63.00	±0.20

A4	2013/08/27	更改供應商變更印字內容	-----
A3	2013/07/03	變更印字內容	-----
A1	11/03/11	將非標規格刪除變更印字內容&變更排線厚度	-----
A0	10/09/13	NEW	-----
REV	DATE	MODIFICATION DESCRIPTION	CHANGE
1			DM

OPERATION	DRAW	DATE	SCALE	FIT
XX	JYHuang	2013/08/28	UNIT	mm
X,XX	CHECK	DATE	SIZE	A4
X,XXX	CHECK	DATE	SHEET	1/1
Angle	APPROVE	DATE	PROJ.	
± 3'				
TOL				

OPERATION	DRAW	DATE	SCALE	FIT
XX	JYHuang	2013/08/28	UNIT	mm
X,XX	CHECK	DATE	SIZE	A4
X,XXX	CHECK	DATE	SHEET	1/1
Angle	APPROVE	DATE	PROJ.	
± 3'				
TOL				

OPERATION	DRAW	DATE	SCALE	FIT
XX	JYHuang	2013/08/28	UNIT	mm
X,XX	CHECK	DATE	SIZE	A4
X,XXX	CHECK	DATE	SHEET	1/1
Angle	APPROVE	DATE	PROJ.	
± 3'				
TOL				

OPERATION	DRAW	DATE	SCALE	FIT
XX	JYHuang	2013/08/28	UNIT	mm
X,XX	CHECK	DATE	SIZE	A4
X,XXX	CHECK	DATE	SHEET	1/1
Angle	APPROVE	DATE	PROJ.	
± 3'				
TOL				

Part NO. F1U-B28GXXD0-XXXX-X
 TITLE: UL2651 1.0mm 28AWG 灰排线
 Customer NO.

WCON
 Http: www.wcon.com

WCON-Dongguan
 Tel: +86 769 85358920
 Fax: +86 769 85358915
 E-mail: sales@wcon.com

WCON-Kunshan
 Tel: +86 512 57468408
 Fax: +86 512 57468468
 E-mail: sales@wcon.com