

# HSF

**NOTES:**

- Current Rating: 7.0AMP
- Contact Resistance: 50mΩ Max
- Withstand Voltage: 1000V AC/DC
- Insulation Resistance: 1000MΩ Min
- Operation Temperature: -40°C to +105°C
- Contact Material: Phosphor Bronze
- Contact plating: Sn over Ni
- Insulator Material: LCP+30%G.F UL94V-0

## Ordering Information

2889 - 1 XX S XX DUNT 1

No. of Pins per Row: 92-30PIN  
 S=Sn-Tin  
 SM=Matte Tin  
 T=Tube

Item	Pitch	Mating
Standard	3.96	1832
Alternate		

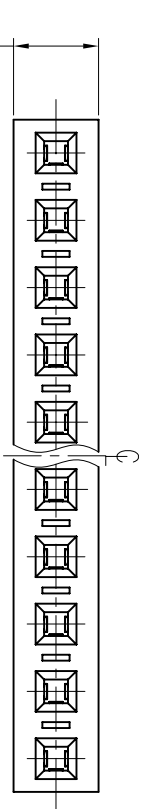

Recommended P.C.B Layout (Top Side)  
 (PCB BOARD TOLERANCE±0.05)

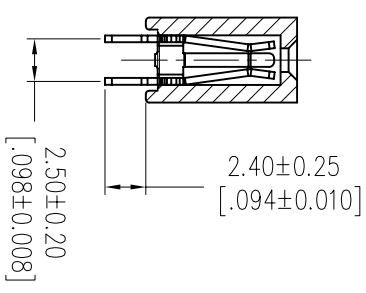
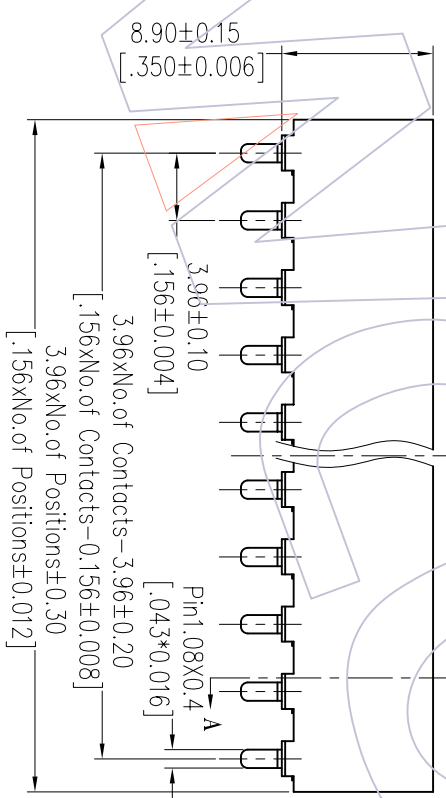
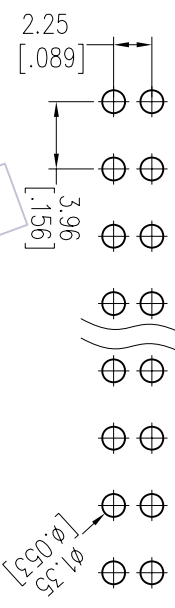

OPERATION		DRAW		DATE		SCALE		FIT		PART NO.	
XX	±0.40	JYHuang		2012/08/18		mm				2889-1XXSXXDUNT1	
CHECK		CHECK		DATE		SIZE		SHEET		TITLE:	
X.XXX	±0.15					A4		1/1		FH3.96 SINGLE ROW 180° DIP H=8.9	
Angle		APPROVE		DATE		PROJ.		SHEET		Customer NO.	
± 3'	TOL							1/1			
CHANGE		APPROVE		DATE		PROJ.		SHEET		Customer NO.	
								1/1			
MODIFICATION DESCRIPTION		APPROVE		DATE		PROJ.		SHEET		Customer NO.	
NEW								1/1			
DATE		APPROVE		DATE		PROJ.		SHEET		Customer NO.	
2012/08/18								1/1			
REV		APPROVE		DATE		PROJ.		SHEET		Customer NO.	
A0								1/1			

# WCON

Http: www.wcon.com  
 WCON-Dongguan Tel: +86 769 85358920 Fax: +86 769 85358915 E-mail: sdles@wcon.com  
 WCON-Kunshan Tel: +86 512 57468408 Fax: +86 512 57468468 E-mail: sdles@wcon.com